

ȘOS. HÂNCEȘTI, TELECENTRU, CHIȘINĂU

Surface, m2

57.3

Rooms

1

Floor

5/10

Building type

New building

Real estate condition

White variant

Balconies

2

Heating

Autonomous

Bathrooms

1

Sale

79 074 €

Adrian Plugaru

078 028 777



1-bedroom apartment with living room for sale, available with installment payment plan. Located in Telecentru sector, Hâncești Highway.

Braus Millennium Park residential complex, developed by Braus Imobiliare.

Total area: 57.3 sq.m

Layout: kitchen, bedroom, living room, bathroom, 2 balconies

Features:

- Delivered in white finish
- Autonomous heating
- Earthquake-resistant structure (up to magnitude 8 on the Richter scale)
- Generous ceiling height of 3 meters
- Underfloor heating
- Brikston red brick walls for durability and thermal insulation
- Soundproof and energy-efficient windows
- Ventilated façade made of ceramic granite
- Two-level underground parking with sufficie



Localizare pe hartă

 ȘOS. HÂNCEȘTI, TELECENTRU, CHIȘINĂU

Adrian Plugaru

078 028 777







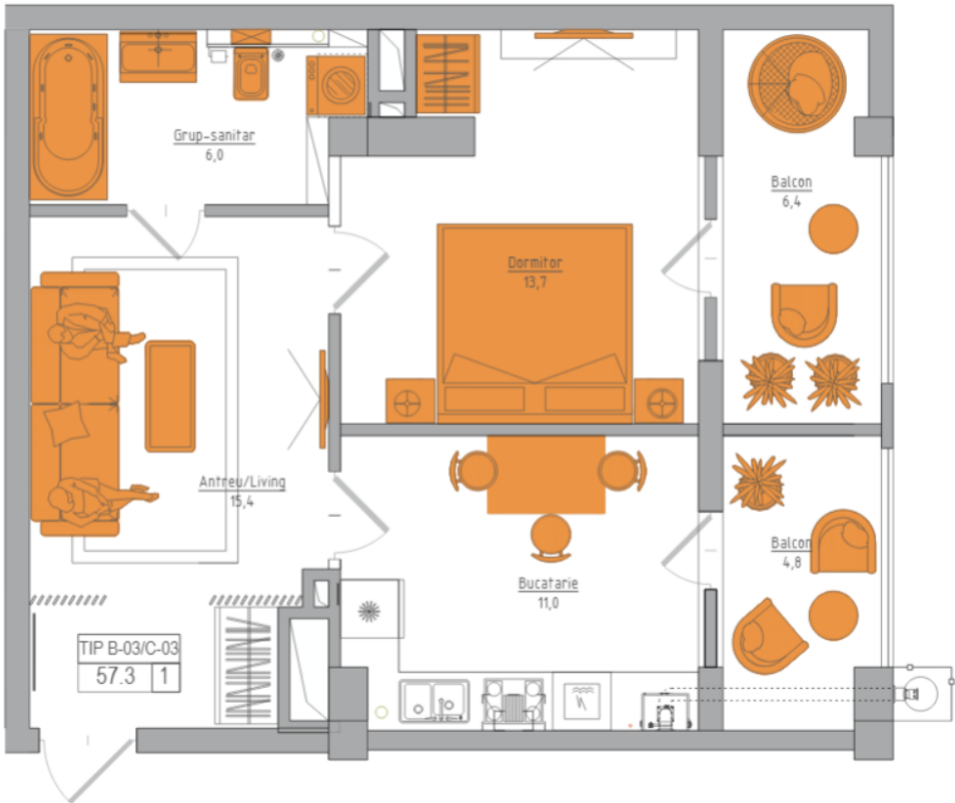



 STR. ARMENEASCĂ, 23

 +37378001717

 OFFICE@MIRAX.MD